

# D191 Gas Valve

## Materials

PART	MATERIAL	QUANTITY
Hex-Nut	Dacromet Plated Steel	1
Handle Sleeve	PVC Yellow	1
Handle	Dacromet Plated Steel	1
Packing Nut	Brass CW617N	1
Packing Gland	PTFE	1
Body	DZR Brass CW602N	1
Ball	DZR Brass CW602N	1
Seats	PTFE	2
O-Ring	NBR with BS EN549 approval	1
Bonnet	DZR Brass CW602N	1
Stem	DZR Brass CW602N	1



## Dimensions and Weights

SIZE	WEIGHT (g)	L (mm)	L1 (mm)	L2 (mm)	H (mm)
1/4"	152	46	12	89	41
3/8"	136	46	12	89	41
1/2"	205	59	15.5	98.5	48
3/4"	302	67	17	98.5	51
1"	511	80.5	21	125	63
1 1/4"	890	94	23	140	78
1 1/2"	1292	102	23	140	83.5
2"	2238	124	26.5	165	97.5

## Dimensional Drawing

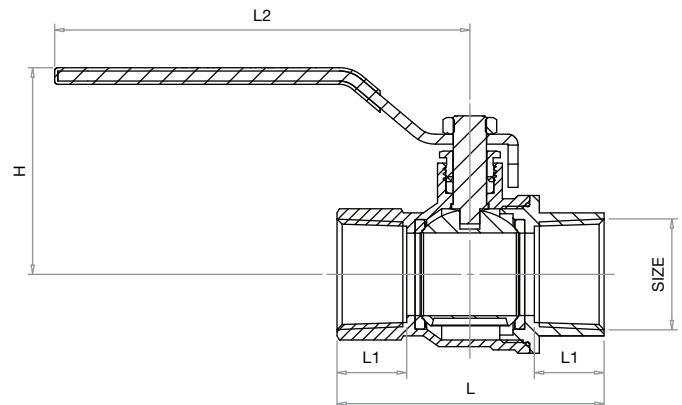

All dimensions are nominal.

## Pressure/Temperature Ratings

### NON GAS APPLICATION

TEMPERATURE °C	-10 to 100	110
PRESSURE (bar)	25	23.5

### GAS APPLICATION

TEMPERATURE °C	-20 to 60
PRESSURE (bar)	5

Intermediate pressure ratings shall be determined by interpolation

**PRESSURE RATING:** PN25

**UK END CONNECTION:** BS EN 10226-2: 2005  
formerly BS21 Taper

**US END CONNECTION:** ANSI B1.20.1:1983

**OPERATOR:** Lever

**SPECIFICATION:** Quarter Turn, PTFE seats and stem seal.  
Tested by GL Industrial Services and complies with the essential requirements of BS EN 331: 1998



CRANE HOUSE  
EPSILON TERRACE,  
WEST ROAD, IPSWICH  
SUFFOLK IP3 9FJ

TELEPHONE: +44 (0) 1473 277 300  
FAX: +44 (0) 1473 277 301  
EMAIL: enquiries@cranefs.com  
[www.cranefs.com](http://www.cranefs.com)

The Company reserve the right to amend any product without notice.

CFS\_DZR\_03\_2010