

# DOUBLE CHECK VALVES

## D220W / D220CW

### Double Check Valves



PN10

#### Features & Benefits

- Double check valves are used to prevent the risk of backflow and back siphonage contamination in domestic dwellings, public and commercial buildings
- WRAS Approved for use with wholesome (potable) water to 60°C
- Supplied with compression ends complying with BS EN 1254-2 for use with BS EN 1057 R250 (half hard) copper tube or female taper threads complying with BS EN 10226-2
- Shell pressure rating for D220W and D220CW is PN16 with a maximum inlet/working pressure of 10 bar

#### Materials

| PART                  | MATERIAL         | SPECIFICATION      |
|-----------------------|------------------|--------------------|
| Body                  | DZR copper alloy | BS EN 12165 CW602N |
| Cartridge             | Acetal           | -                  |
| 'O' ring              | NBR / EPDM       | -                  |
| Compression Nut       | Brass            | BS EN 12164 CW617N |
| Olive                 | Brass            | -                  |
| Plating (compression) | Nickel Plated    | -                  |
| Plating (Threaded)    | Unplated         | -                  |

#### Dimensions & Weights

##### Compression - D220CW

| SIZE (mm) | A (mm) | B (mm) | C (mm) | D (mm) | WEIGHT (kg) |
|-----------|--------|--------|--------|--------|-------------|
| 15        | 79     | 62     | 24.5   | 24     | 0.15        |
| 22        | 92     | 75     | 27.5   | 31.5   | 0.19        |
| 28        | 107    | 89     | 30.5   | 39     | 0.29        |

##### Threaded - D220W

| SIZE (inch) | A (mm) | B (mm) | C (mm) | WEIGHT (kg) |
|-------------|--------|--------|--------|-------------|
| 1/2         | 64     | 18     | 24     | 0.15        |
| 3/4         | 78     | 21     | 32     | 0.24        |
| 1           | 77     | 25     | 38     | 0.36        |
| 1 1/4       | 124    | 28.5   | 46     | 0.4         |
| 1 1/2       | 141    | 32.0   | 53     | 0.5         |
| 2           | 182    | 37.5   | 64     | 0.8         |



D220W

PUBLIC HEALTH

#### Dimensional Drawing

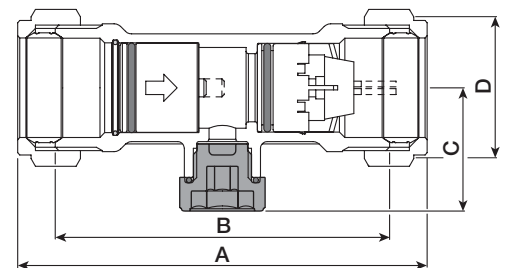

Compression

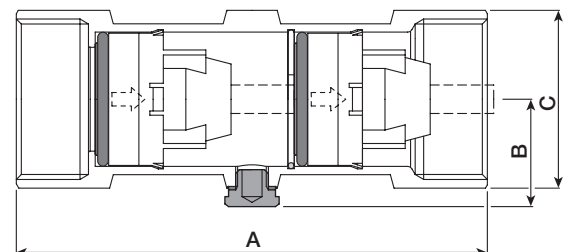

Threaded

#### Pressure/Temperature Ratings

|                      | COMPRESSION | THREADED  |
|----------------------|-------------|-----------|
| TEMPERATURE (°C)     | -10 to 85   | -10 to 85 |
| SHELL PRESSURE (BAR) | 16          | 16        |

**SHELL PRESSURE RATING:** PN16

**MAX INLET/WORKING PRESSURE:** 10 bar

WRAS APPROVED: 10 bar

**MIN OPENING PRESSURE:** 0.2 bar

**END CONNECTIONS:** Compression to BS EN 1252-2 and taper female threaded to BS EN 10226-2

**APPLICATION:** Water

**TEMPERATURE RATING:** 85°C maximum - WRAS Approved to 60°C

PED: This valve is suitable for use on group 2 liquids only as defined by the Pressure Equipment Directive 2014/68/EU

Valid as of 12018

Every effort has been made to ensure that the information contained in this publication is accurate at the time of publishing. Crane Ltd assumes no responsibility or liability for typographical errors or omissions or for any misinterpretation of the information within the publication and reserves the right to change without notice.