

DM950G / DM950L



DM950G

Gearbox Operated
Flow Measurement & Regulating Valve

PN16

Features & Benefits

- The DM950G and DM950L consist of a DM925G/L coupled with a fixed orifice flow measurement device using a spool piece connector, to form a fixed orifice flow measurement unit with regulation and isolation capability
- The DM950G and DM950L is supplied ready assembled to site
- Test points are supplied loose
- Suitable gasket and bolting should be provided by the contractor/installer



Materials

PART	MATERIAL	SIZES
Extension Piece	Steel DIN 17100 R.St.37.2/ASTM A53.Gr.A	150-400
Extension Piece	Steel DIN 17100 R.St. 37.2	50-125
P84 Test Valve	See Fig No P84	All
Orifice Plate Retain	Steel DIN 17100 R.St. 37.2	All
Orifice Plate	Stainless Steel BS 970 316S31	All
Orifice Plate Gasket	Asbestos Free	All
Flange Bolts	Steel BS 3692 Gr. 8.8	All
DM925G	See Fig. No DM925G Gear Operated	All
Test Point Extension	DZR Brass BS EN 12164 CW602N	All
Test Point Adaptor	DZR Brass BS EN 12164 CW602N	50-125
Socket Head Cap Screw	Steel BS 4168 Gr. 12.9	All

Dimensional Drawing

Figure 1: DM950G

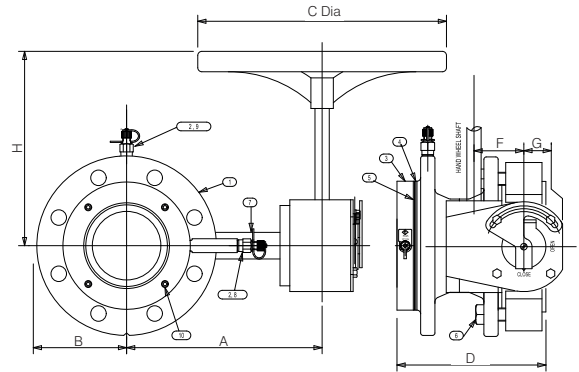

Dimensions & Weights

SIZE (mm)	WEIGHT (kg)	DM950G (Fig 1)							DM950L (Fig 2)			
		A (mm)	B (mm)	C (mm)	D (mm)	F (mm)	G (mm)	H (mm)	I (mm)	J (mm)	K (mm)	L (mm)
50	19.7	148	83	150	158	45	54	157	174	83	213	158
65	18.2	171	93	150	161	45	54	157	197	93	213	161
80	20.9	173	100	150	171	45	54	157	204	100	213	171
100	27.0	202	110	150	181	45	54	157	235	110	213	181
125	38.4	208	125	150	190	45	54	157	234	125	213	190
150	47.1	218	143	150	232	45	54	157	250	143	245	232
200	67.8	263	170	300	287	45	54	238	300	170	378	286
250	86.6	306	203	300	345	63	81	238	-	-	-	-
300	120.6	337	230	300	404	78	81	224	-	-	-	-
350	175	406	260	300	451	78	130	226	-	-	-	-
400	250	447	290	450	511	120	130	277	-	-	-	-

Figure 2: DM950L

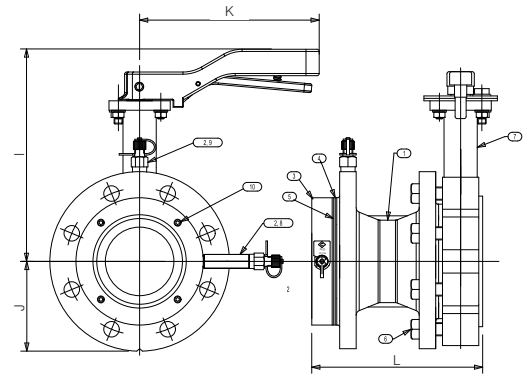

Coefficients*

SIZE (DN)	FLOW (Kv)	HEADLOSS (K)	KVS
50	58	3.4	46.1
65	114	2.6	90
80	168	2.3	120
100	303	2.0	220
125	479	1.8	342
150	649	1.8	468
200	1113	1.6	792
250	1713	1.6	1224
300	2656	1.5	1800
350	2754	1.3	1795
400	3573	1.3	2334

Pressure/Temperature Ratings

TEMPERATURE (°C)	-10 to 120
PRESSURE (BAR)	16

Note: 350mm and 400mm limited to 110°C.

Valid as of 30/01/20

Every effort has been made to ensure that the information contained in this publication is accurate at the time of publishing. Crane Ltd assumes no responsibility or liability for typographical errors or omissions or for any misinterpretation of the information within the publication and reserves the right to change without notice.