

143XU

Cast Steel Globe Valve

Class 150

143XU



GENERAL VALVES

Features & Benefits

- Ideal for throttling service
- Flow characteristics permit accurate and repeatable flow control
- Seat ring is seal welded to eliminate leak paths
- Outside screw & yoke
- Bolted bonnet

Materials

PART	MATERIAL
Body	A216 WCB
Bonnet	A216 WCB
Seat Rings	Hardfaced
Disc	ASTM A105 + STL
Stem	ASTM A182 F6a Cl. 2. This is equivalent to SS410
Packing	ASTM A276 304 + Graphite
Bonnet Gasket	ASTM A276 304 + Graphite
Back Seat	410 SS
Disc Stem Nut	Steel
Disc Washer	Carbon Steel
Gland	410 SS
Gland Flange	WCB
Eye Bolt	Steel
Eye Bolt Nuts	Steel
Pins	-
Bonnet Studs	A193 Gr. B7
Bonnet Nuts	A194 Gr. 2H
Handwheel	ASTM A536 65-45-12
Handwheel Nut	A194 Gr. 2H
ID Tags	SS
ID Pins	Steel

Dimensional Drawing

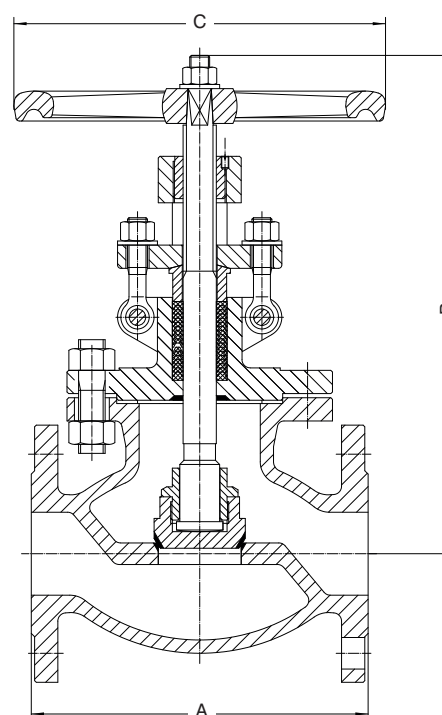

Dimensions & Weights

SIZE (inch)	WEIGHT (kg)	A (mm)	B VALVE OPEN (mm)	C (mm)
2	17.4	203	327	200
2 1/2	24	216	366	240
3	31.8	241	418	240
4	44.6	292	446	280
6	88	406	590	400
8	143	495	702	450
10	233	622	983	440
12	268	698	1190	540

Industry Standards

PRESSURE/TEMPERATURE	ANSI B16.34
FACE-TO-FACE/END-TO-END	ANSI B16.10
FLANGE DIMENSIONS	ANSI B16.5
TESTING	API 598
DESIGN	API 623

Intermediate pressure ratings shall be determined by interpolation.

SIZE RANGE: 2 - 12 inches **PRESSURE TEMPERATURE RATING:** Class 150

Sizes 10" and 12" are Carbon Steel
 Gearbox operated ASTM A216 Grade WCB
 19.6 Bar / -29 to 38°C
 5.5 Bar / 425°C

Valid as of 250620

Every effort has been made to ensure that the information contained in this publication is accurate at the time of publishing. Crane Ltd assumes no responsibility or liability for typographical errors or omissions or for any misinterpretation of the information within the publication and reserves the right to change without notice.