

# D140W

## Swing Check Valves



D140W

PN25



GENERAL VALVES

### Features & Benefits

- Check Valves permit flow in one direction only and close automatically if flow reverses
- They are entirely automatic in action, depending upon pressure and velocity of flow within the line to perform their functions of opening and closing
- Conforms with BS 5154:1991 and generally conforms with MSS SP 80.

### Materials

PART	MATERIAL	SPECIFICATION	SIZES
Body	Bronze	BS EN 1982 CC491K	All
Cap	Bronze	BS EN 1982 CC491K	All
Disc Holder	Brass	BS EN 12164 CW614N	3/4 - 1
Disc Holder	Bronze	BS EN 1982 CC491K	1 1/4 - 2
Disc	WRAS Approved Nitrile Rubber		All
Disc Retaining Nut	Brass	BS EN 12164 CW614N	All
Washer	Brass	BS EN 12164 CW614N	All
Hinge	Bronze	BS EN 1982 CC491K	All
Hinge Pin	Stainless Steel		All
Hinge Nut	Brass	BS EN 12164 CW614N	All

### Dimensional Drawing

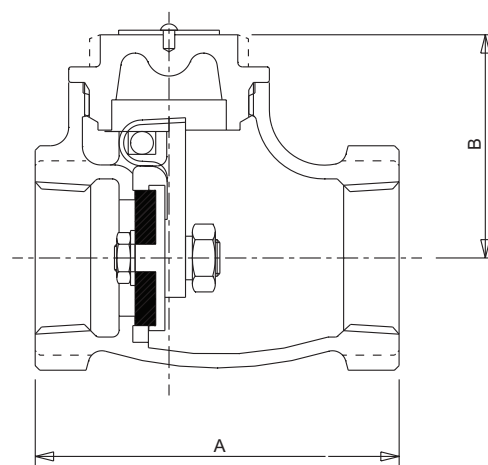

### Dimensions & Weights

SIZE (inch)	WEIGHT (kg)	A (mm)	B (mm)
3/4	0.43	66	42
1	0.63	80	49
1 1/4	1.01	89	56
1 1/2	1.34	95	65
2	2.12	108	76

### Pressure/Temperature Ratings

TEMPERATURE (°C)	-10 to 85
PRESSURE (BAR)	25

**MIN OPENING PRESSURE:** 4 kPa**MAX OPERATING PRESSURE:** PN25**TEMPERATURE OPERATING RANGE:** -10 to 85°C**UK END CONNECTIONS:** Taper threaded to BS EN 10226-2 (ISO 7-1) OPERATOR: Swing type Check Valve

**SPECIFICATION:** Bronze Swing Check Valve, Screwed Cap, in accordance with BS 5154:1991, PN25 rated. Valve Body, Cap and hinge to BS EN 1982 CC491K. Nitrile Rubber coated Brass and Bronze disc. BSI Kitemark approved. WRAS approved for use with potable water.

**MSS SP80 CONFORMANCE:** D140W complies with MSS SP 80, however, valve markings and threaded ends confirms with BS EN 12288:2010 only. D140W.AT complies with threaded ends as well.

The Valve is suitable for use in group 2 liquids only, as defined by the Pressure Equipment Directive 2014/68/EU.\*

\* See page xx for more information