

DE40BS DN15/15

Dominator Eco with BSRIA
Flushing Drain & Strainer

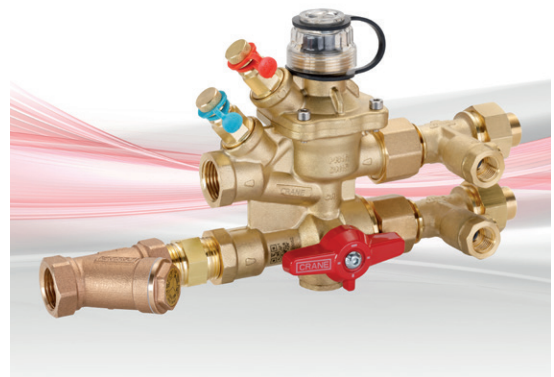

PN16



ProBalance

bunstore

Features & Benefits

- Innovative design - Unique differential pressure mechanism, ensuring accurate flow control and allowing the valve to be back flushed if required. Patent Pending
- Reduced embodied carbon and simple installation by combining a PICV, H-body and FMD together, making the Dominator Eco 36% lighter and 22% shorter than our current 40mm Dominator alternative
- Reliable flow measurement through the integral FMD in accordance to BS 7350
- Easily identifiable chilled and heating applications via the colour coded tags that also display the fan coil reference
- Paperless - Digital datasheet, IOM and commissioning tool can be quickly accessed via QR code on the colour coded tags
- BSRIA BG29 compliant design - Full forward-flushing and back-flushing capabilities
- Peace of mind - 100% of Dominator Ecos are tested before shipping. This involves pressure testing to BS EN 12266-1 and performance testing in accordance with BSRIA BTS01
- Direct mounting to FCUs – designed for easy access to components in confined spaces
- Flow regulation and ΔP verification – Utilising setting dial and integrated test points
- System performance maintained - Fitted strainer helps filter particles and impurities in the fluid maintaining system cleanliness (if cleaned regularly)
- Comprehensive flow range available, allowing for cost effective valve selections
- PN16 rated product, suitable for building services applications
- Increased functionality and reduced material requirement - Interchangeable test points and nozzles facilitate ΔP measurement and flushing where required

Materials

NO.	DESCRIPTION	MATERIAL	QTY
1	Male Ended Low Flow 0.010 - 0.080l/s Male Ended Std. Flow 0.025 - 0.170l/s Male Ended High Flow 0.110 - 0.290l/s	DZR Brass BS EN 12165 (CW602N)	1
2	Drain Tee Assembly – Male Captive	DZR Brass BS EN 12165 (CW602N)	2
3	End Connection Sub Assembly	DZR Brass BS EN 12164 (CW602N)	2
4	Nipple - 1/2" Part	DZR Brass BS EN 12165 (CW602N)	1
5	PN16 Strainer - D298	Bronze BS EN 1982 CC491K	1

NOTE: Sealing gasket and O-rings material are EPDM

PICU Pressure

OPERATING PRESSURE RANGE	20 - 400 (DN15 LF)
ACROSS VALVE (kPa)	20 - 400 (DN15 SF)
	40 - 400 (DN15 HF)

PRESSURE RATING: PN16

TEMPERATURE RATING: 0 to 90°C

WEIGHT 1.8kg

END CONNECTIONS:

Valve body - BSP Taper
Terminal end - Compression/Solder

SPARES: Refer to IOM

SPECIFICATION DZR Terminal unit valve set to be a pre-assembled unit as supplied by a single manufacturer. Unit to include a flushing bypass with integral isolation valves, Pressure Independent Commissioning Unit (PICU), strainer and flushing valves to comply to BG29 guidelines. Flow rate to be measurable using integral test points as per BS 7350. Flow rate to be adjustable between 0.010-0.290l/s, dependent on variant. Connections to be flat face unions between components with female BSPT on system side and compression/solder on terminal side. Unit to be manufactured from DZR Brass to BS EN 12164/5 CW602N. Valve assembly will be labelled to include the terminal unit reference number, service and part number as per Dominator Eco.

Dimensional Drawings

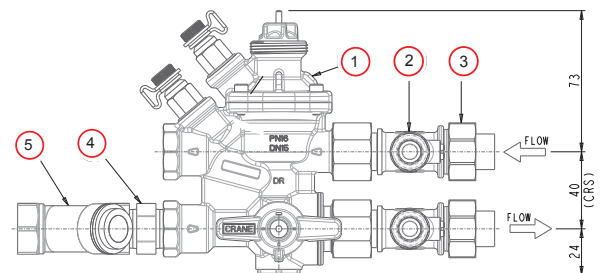

Available in standard or reverse handed orientations.

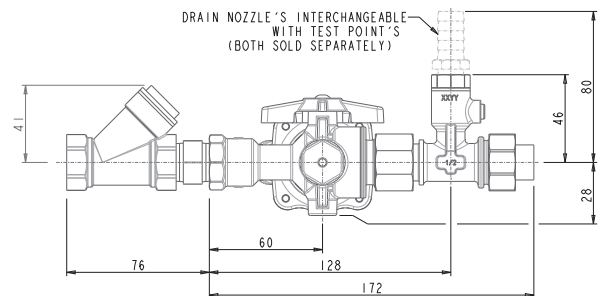

End Connections

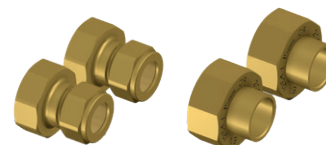

Compression

Solder

*15mm only